

**glassBOARDS > FLUSH FRAME** > Using an elegant profile, the Flush Frame glassBOARD incorporates a clean, linear aesthetic detail to the perimeter of each panel edge. Match the frame to the board color or offset it with a complementary, contrasting finish. The Flush Frame design delivers a premium image at a moderate price. Select from a variety of sizes and applications that meet the requirements in your facility and captivate the user.

#### GLASS

Low-Iron Tempered.

#### GLASS FINISHES

Opaque (B).

#### SURFACES

Smooth (S), WriteEtch (W, writable) and Etch (E, non-writable).

#### MOUNTING ORIENTATION

Horizontal, Vertical or Square. Standalone or side-by-side. Combine with glassWALLCLAD, glassTACKBOARDS and glassMIRRORS for a full wall mosaic.

#### THICKNESS

1/2" including the frame.

#### STANDARD WIDTHS (inches):

24, 30, 36, 42, 48, 54, 60, 66, 72, 78, 84, 90, 96, 102, 108, 114 and 120

#### STANDARD HEIGHTS (inches):

24, 30, 36, 42, 48 and 60

#### FUNCTION

Writable with markers without ghosting; Smooth (S) and WriteEtch (W) only. Non-Magnetic and Magnetic.

#### MOUNTING HARDWARE

Concealed wall-mounted Z-Clip bracket.

#### FRAME FINISHES

Standard Aluminum or 23 powder-coat colors at an upcharge.

#### ACCESSORIES

Magnetic and adhesive face-mounted Marker Holders, Trays, Erasers and Rare-Earth Magnets.

#### CUSTOMIZATION

Special sizes or finishes available upon request.

#### WARRANTY

10-year product assurance.

## Features

- Finished artistic appeal
- Premium, tint-free low iron glass
- Evenly balanced, low-VOC, 100% opaque backpaint
- Superior long-term construction and durability
- Broadest selection of size and finish options
- Design standard compatibility with multiple Carvart products
- Quick and easy installation
- Produced in America



Corner

## Specification Notes

- Panels up to 120" may require special considerations to transport into a building which is the responsibility of the dealer and their installer.
- Permanent markers are not recommended as appropriate for glass surfaces.



Details

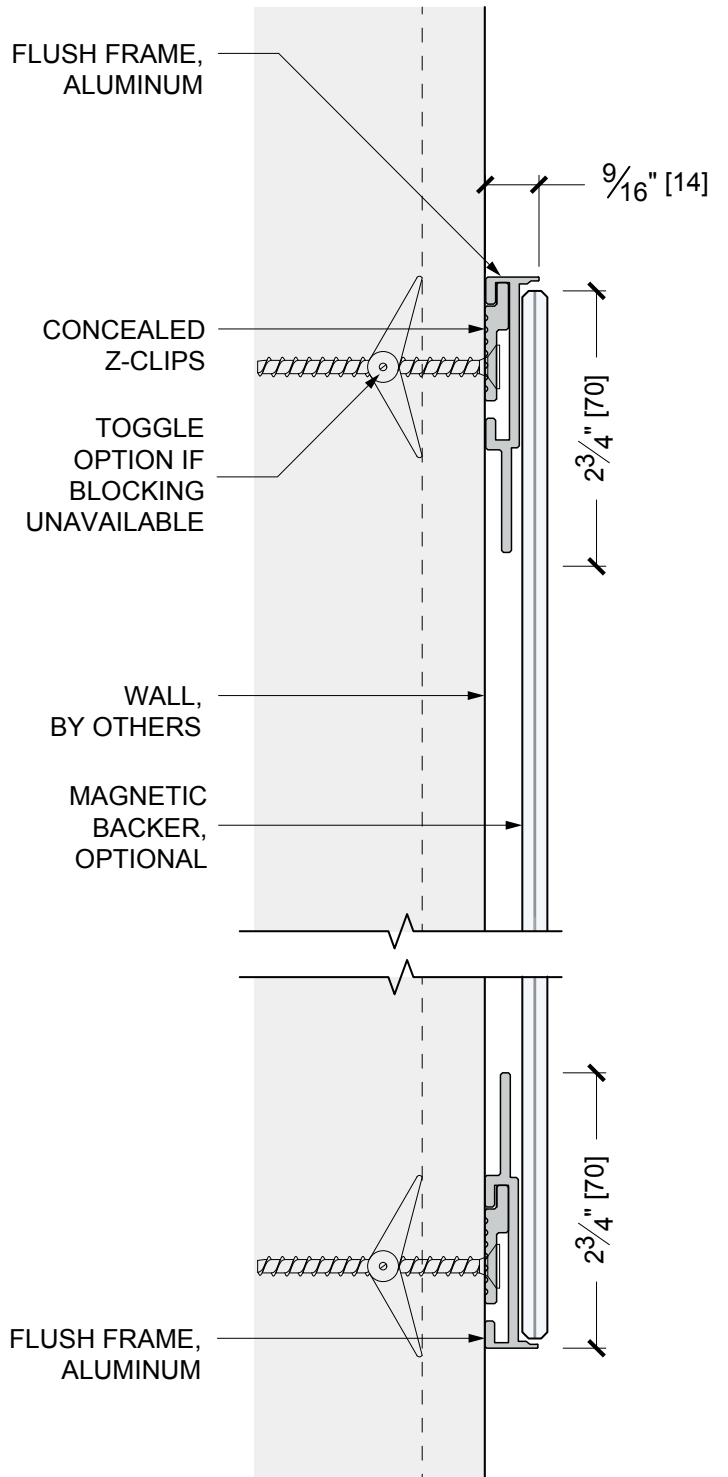
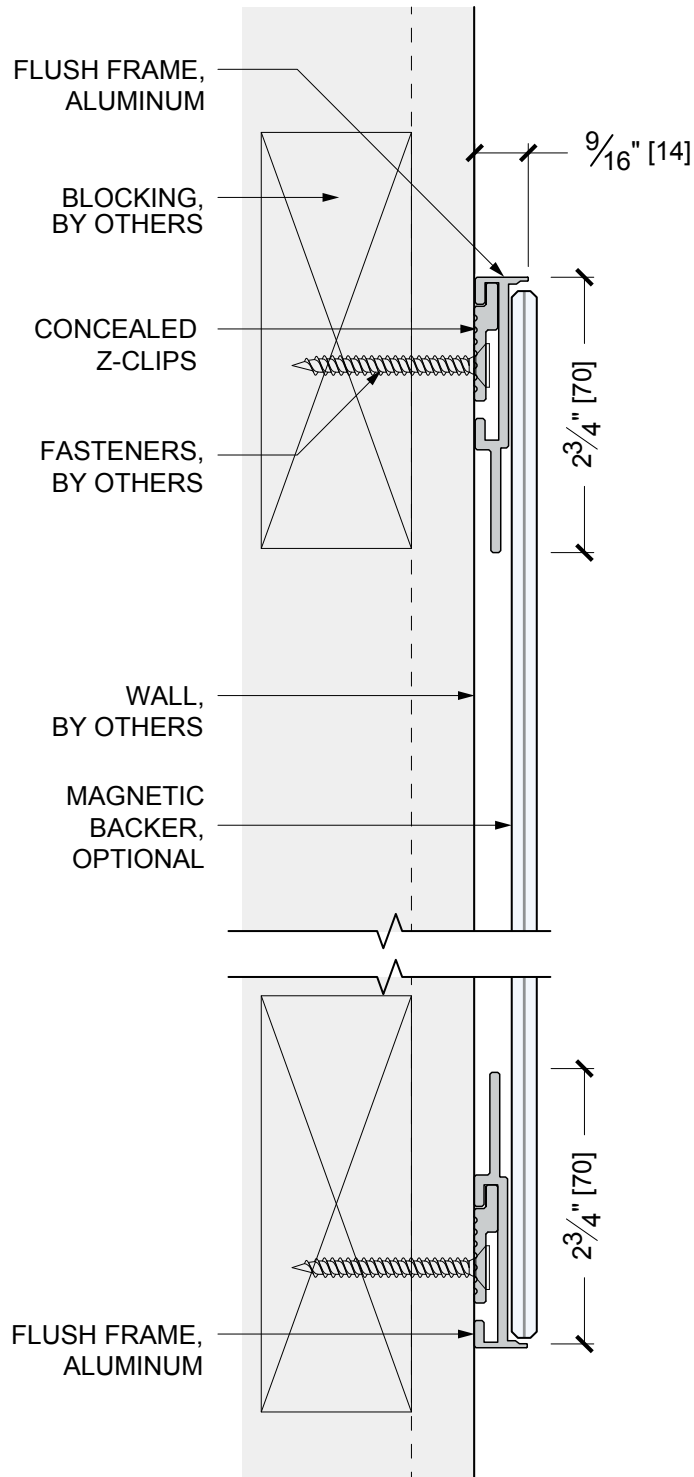

## Surfaces

**Smooth (S)** is the most common characteristic of clear glass, prominent in all aspects of everyday life.

- Writable with erasable markers.
- Normal expected glare and fingerprinting.
- Reflective.
- Non-oil absorbing.
- Suggested for horizontal and vertical applications.
- Cleans easily with common glass cleaners.

### Opaque



**WriteEtch (W)** is an innovative surface that resists stains and is non-reflective. The surface is slightly-abraded which results in a softer, uniform frosted appearance.

- Writable with erasable markers.
- Glare and fingerprints are minimized.
- Uniform frosted appearance.
- Non-oil absorbing.
- Recommended mainly for vertical applications.
- Cleans easily with common glass cleaners at a more occasional rate than Smooth glass.



**Etch (E)** is a smudge-proof glass surface that is slightly-abraded and allows for a high degree of light transmission. Its pleasant diffusing of light and imaging through the glass can aid privacy in environments.

- NON-Writable.
- Glare and fingerprints are minimized.
- Uniform frosted appearance.
- Non-oil absorbing.
- For horizontal and vertical applications.
- Cleans easily with common glass cleaners at a more occasional rate than Smooth glass.



## Functions

### Non-magnetic (NONMAG)

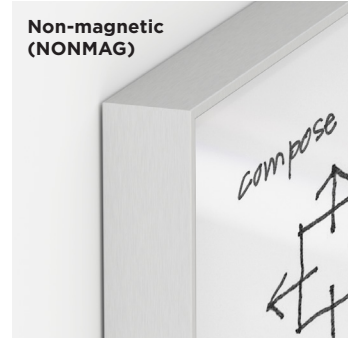

### Magnetic (MAG)



glassACCESSORIES

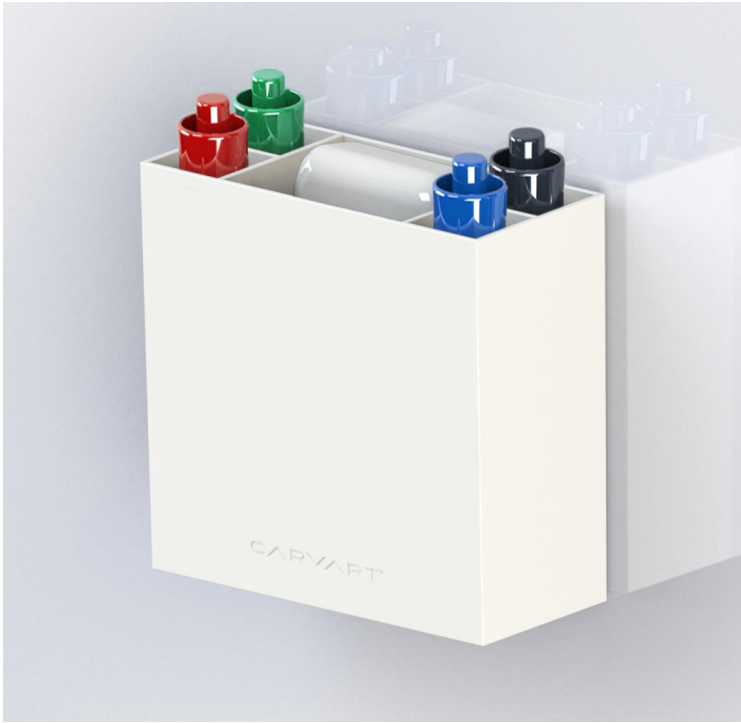

Holder/Marker with Magnetic Adapter



Eraser



Rare-Earth Magnet



Rail

**Opaque  
Glass**



**Opaque  
Glass  
Metallics**



**Frames**

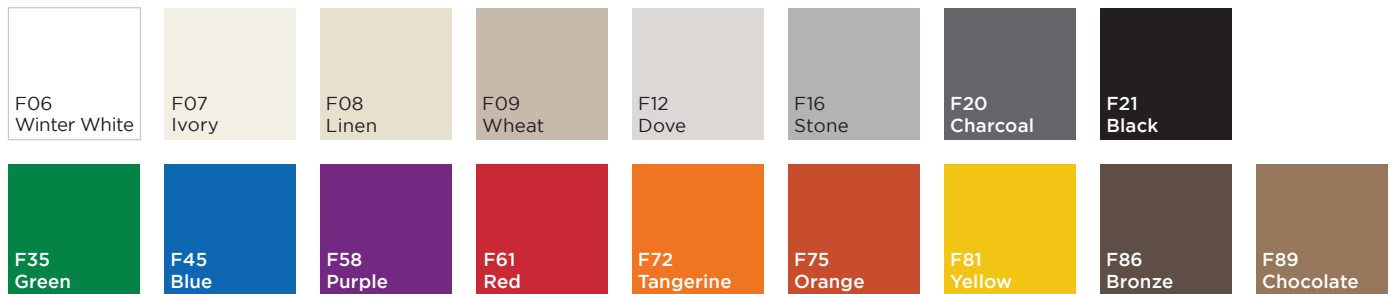

**Frames  
Metallics**

