

**glassMIRRORS** > CARVART offers a full array of simple, stylish reflective mirrors for wall-mounting in bathrooms, locker rooms, breakrooms or general common areas of a facility. Available in a wide variety of sizes, from a small personal size up to large over-sized piece for a featured placement, our mirrors offer the highest possible design, quality and durability. Choose between a multiple of frame designs available in a basic aluminum finish or a wide variety of neutral, metallic and bright powder-coat colors.

**GLASS**  
Annealed with safety backing.

**GLASS FINISHES**  
Mirror (RM).

**SURFACES**  
Smooth (S) and Etch (E, non-writable).

**MOUNTING ORIENTATION**  
Horizontal, Vertical or Square. Standalone or side-by-side. Combine Floating Frameless and Flush Frame designs with glassWALLCLAD, glassBOARDS and glassTACKBOARDS for a full wall mosaic.

**THICKNESS**  
1/2" including frame.

**FRAME OPTIONS**  
Floating Frameless and Flush Frame.

**STANDARD WIDTHS** (inches):  
24, 30, 36, 42, 48, 54, 60, 66, 72, 78, 84, 90, 96, 102, 108 and 120

**STANDARD HEIGHTS** (inches):  
24, 30, 36, 42, 48, 54, 60, 66, 72, 78, 84, 90, 96, 102, 108 and 120

**MOUNTING HARDWARE**  
Concealed wall-mounted Z-Clip bracket.

**FRAME FINISHES**  
Standard Aluminum or 23 powder-coat colors at an upcharge.

**CUSTOMIZATION**  
Special sizes or finishes available upon request.

**WARRANTY**  
1-year product assurance.

Details: Flush Frame

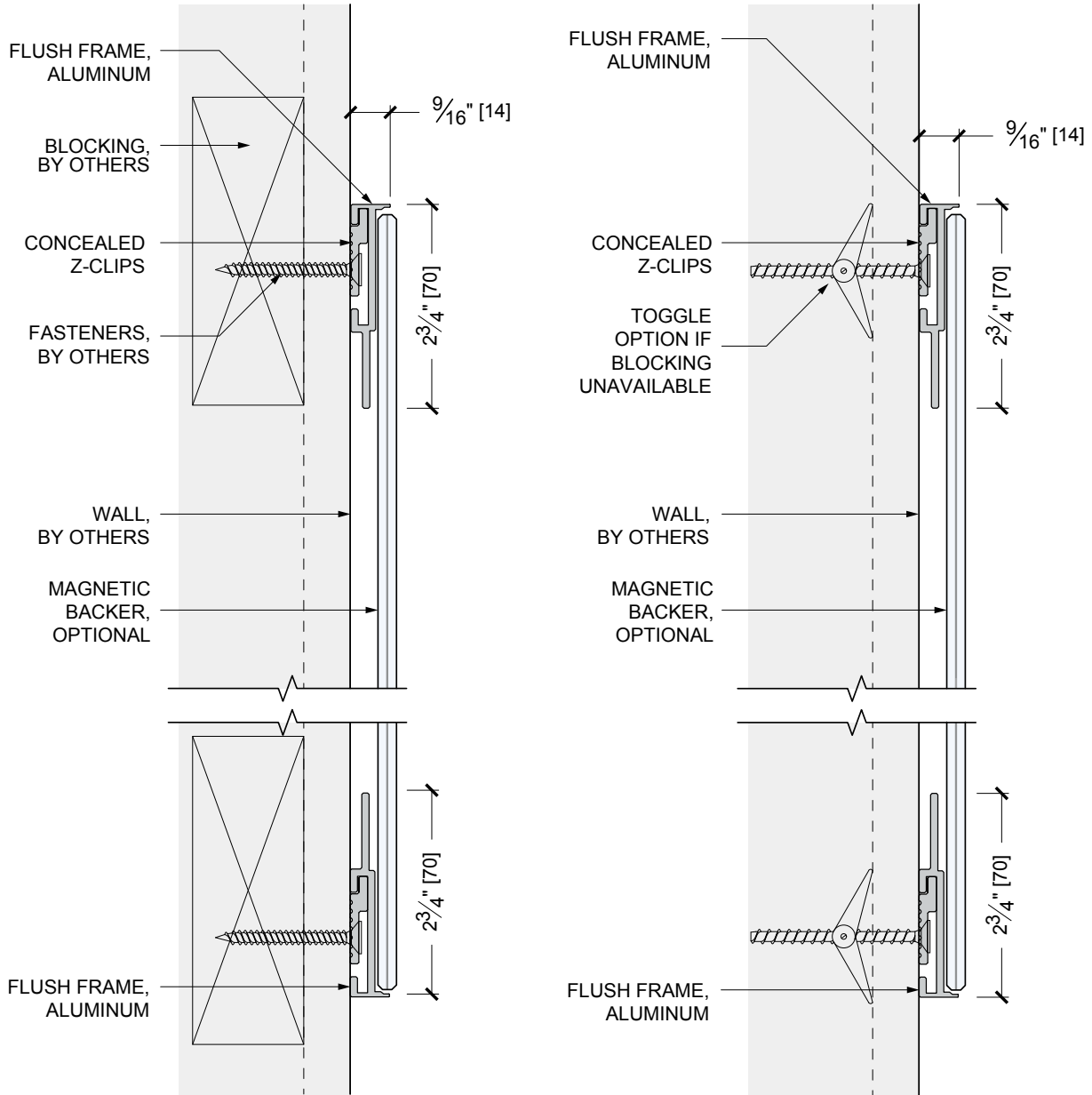

Details: Floating Frameless

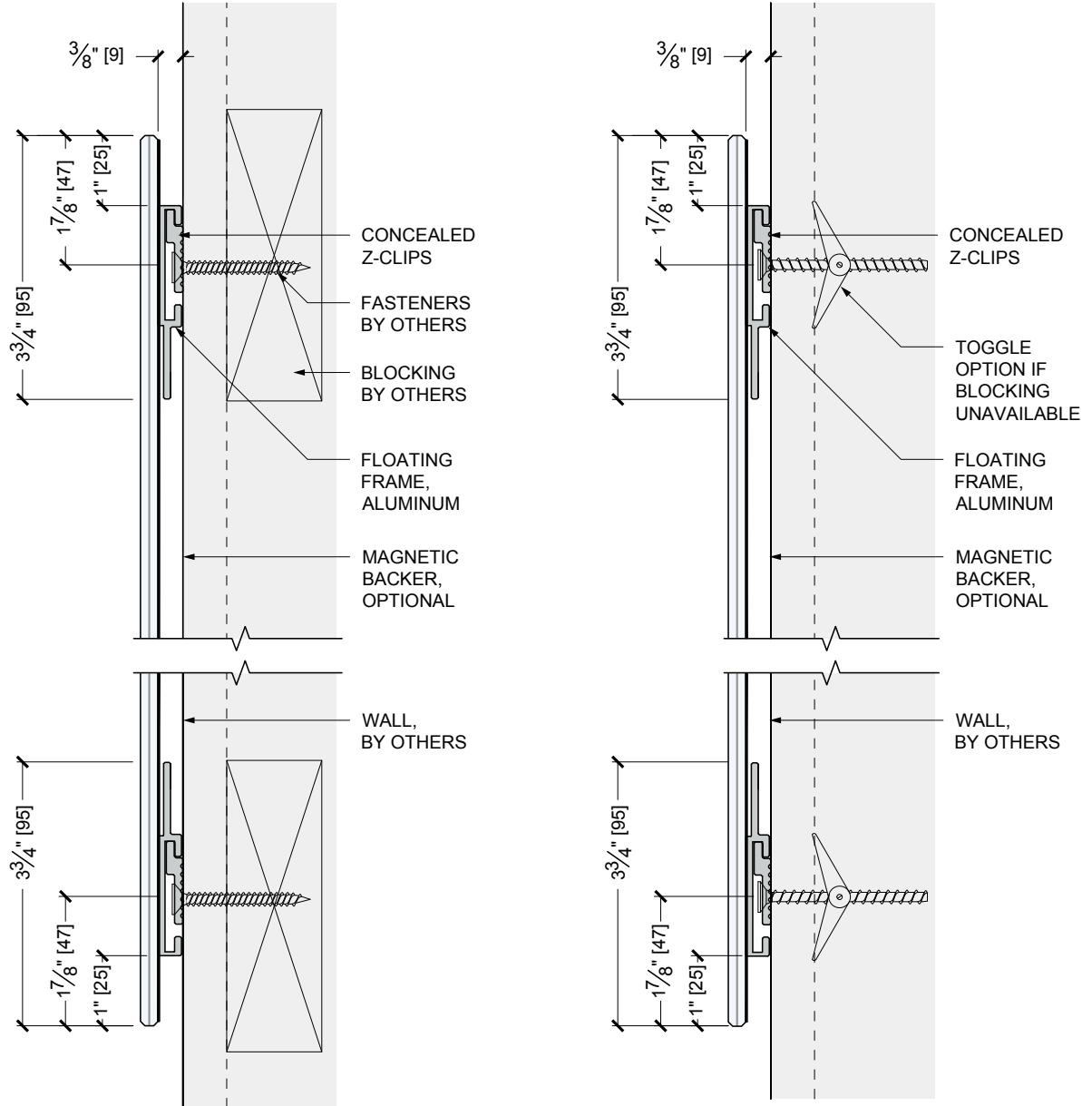

## Surfaces

**Smooth (S)** is the most common characteristic of clear glass, prominent in all aspects of everyday life.

- Writable with erasable markers.
- Normal expected glare and fingerprinting.
- Reflective.
- Non-oil absorbing.
- Suggested for horizontal and vertical applications.
- Cleans easily with common glass cleaners.

### Opaque



**Etch (E)** is a smudge-proof glass surface that is slightly-abraded and allows for a high degree of light transmission. Its pleasant diffusing of light and imaging through the glass can aid privacy in environments.

- NON-Writable.
- Glare and fingerprints are minimized.
- Uniform frosted appearance.
- Non-oil absorbing.
- For horizontal and vertical applications.
- Cleans easily with common glass cleaners at a more occasional rate than Smooth glass.

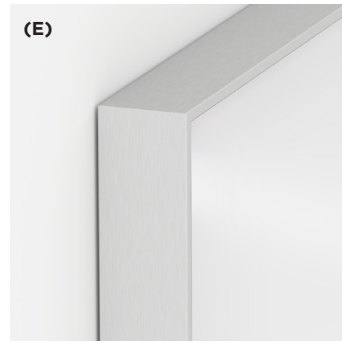

## Functions

### Non-magnetic (NONMAG)

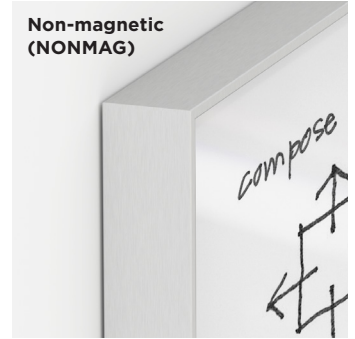

### Magnetic (MAG)



Mirror



Frames

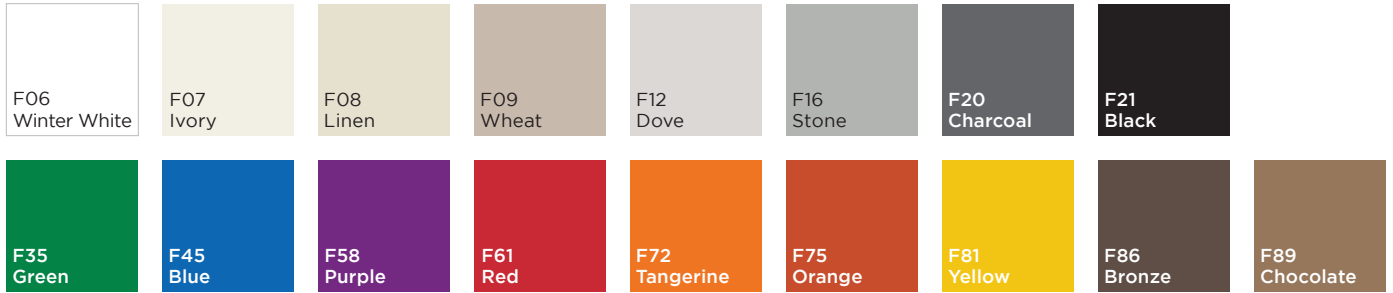

Frames  
Metallics

